

## TRAFFIC SWINGING SINGLE LEAF DOORS

ALL PRICES IN EURO, DO NOT INCLUDE VAT. 2 MM THICK METAL DOOR FRAME INCLUDED

(TSD)

26.03.2025

- PH Insulation's traffic swinging doors are designed to separate production and other premises in places with intensive traffic of personnel.
- The factory-made doors are ready for installation on technological, industrial premises, supermarkets, hospitals, food production facilities, cafes, restaurants, etc.
- Traffic doors are not meant to completely seal the opening due to technical clearance gaps along the perimeter between the frame and the door leaf.
- If you need the doors to remain open in 90-degree position, you can order traffic doors with fixing hinges. Doors can be equipped with oval windows of 200x500 or 300x580 mm.
- Traffic doors are available in custom sizes and are equipped with the European-made hardware: Italian, Spanish, — according to customer's request.

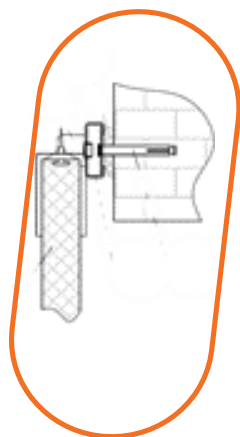

### OVERHEAD FRAME

INSTALLATION OPENING, HEIGHT, MM	INSTALLATION OPENING, WIDTH, MM						
	700	800	900	1000	1100	1200	1300
1800	367	405	413	424	432	448	525
1900	371	411	419	430	438	519	532
2000	375	417	424	437	445	525	539
2100	380	423	431	443	513	533	547
2200	386	430	439	452	522	542	556
2300	393	440	449	524	534	554	634
2400	397	446	455	530	540	561	642
2500	480	531	541	556	567	588	672
2600	486	539	549	565	575	664	682
2700	492	546	556	573	583	672	691
2800	498	554	565	581	657	682	700
2900	565	624	635	654	665	691	709
3000	571	633	645	663	675	701	720
3100	577	641	653	672	684	710	730
3200	583	649	661	681	693	720	740
3300	589	657	669	689	702	729	749

RAL 9003

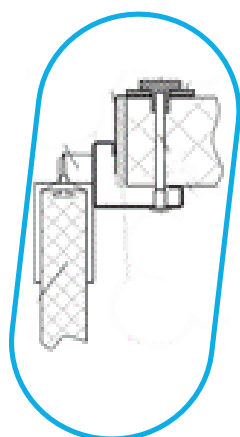

### ANGULAR FRAME

INSTALLATION OPENING, HEIGHT, MM	INSTALLATION OPENING, WIDTH, MM						
	700	800	900	1000	1100	1200	1300
1800	411	450	458	471	482	500	580
1900	416	457	465	478	489	573	588
2000	420	463	472	485	496	580	595
2100	425	470	478	492	566	588	603
2200	430	476	485	499	574	595	611
2300	443	492	501	579	591	614	697
2400	449	499	509	587	599	622	706
2500	533	585	596	613	626	650	737
2600	541	595	606	624	637	729	749
2700	549	606	617	635	649	742	762
2800	555	614	625	643	724	751	771
2900	628	689	702	722	737	765	785
3000	636	700	713	734	749	777	799
3100	642	708	721	742	758	787	808
3200	648	716	730	751	767	796	818
3300	657	727	741	762	778	808	830

RAL 9003





## OVERLAPPING FRAME

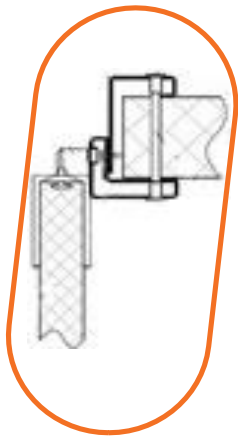

RAL 9003

INSTALLATION OPENING, HEIGHT, MM	INSTALLATION OPENING, WIDTH, MM						
	700	800	900	1000	1100	1200	1300
1800	472	515	525	541	553	574	659
1900	480	524	534	551	563	652	670
2000	491	538	549	565	578	668	687
2100	499	547	558	575	654	679	698
2200	506	556	568	585	664	690	709
2300	521	573	585	669	683	709	799
2400	529	584	596	680	694	721	811
2500	623	680	693	714	729	758	852
2600	634	693	707	728	744	844	867
2700	643	704	718	740	755	856	880
2800	652	715	730	752	837	869	893
2900	730	796	811	835	852	885	909
3000	742	812	828	852	869	903	928
3100	751	823	839	864	881	915	941
3200	758	832	848	873	890	925	951
3300	767	843	859	885	903	938	965

OUR DOORS ARE AVAILABLE IN CUSTOM SIZES TO INSURE BEST COMMERCIAL APPLICATION

## TRAFFIC SWINGING DOUBLE LEAF DOORS

ALL PRICES IN EURO, DO NOT INCLUDE VAT. 2 MM THICK METAL DOOR FRAME INCLUDED

(TDD)

26.03.2025

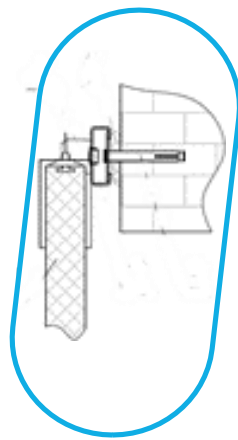

RAL 9003

## OVERHEAD FRAME

INSTALLATION OPENING, HEIGHT, MM	INSTALLATION OPENING, WIDTH, MM				
	1000	1100	1200	1300	1400
1800	665	668	679	682	744
1900	672	675	686	690	755
2000	680	683	695	698	767
2100	687	691	702	706	778
2200	694	699	710	714	790
2300	709	714	725	729	810
2400	726	731	745	749	834
2500	877	881	896	900	990
2600	893	898	912	917	1010
2700				928	1024
2800				940	1040
2900				1083	1187
3000				1094	1201
3100				1105	1218
3200				1118	1234
3300				1129	1249

## OVERHEAD FRAME

INSTALLATION OPENING, HEIGHT, MM	INSTALLATION OPENING, WIDTH, MM				
	1500	1600	1700	1800	1900
1800	748	751	754	758	763
1900	759	762	766	769	775

RAL 9003	2 000	771	774	778	782	787
	2 100	782	786	789	793	799
	2 200	794	798	802	806	812
	2 300	814	818	822	826	961
	2 400	838	842	847	851	988
	2 500	994	999	1 003	1 008	1 014
	2 600	1 014	1 019	1 024	1 029	1 035
	2 700	1 029	1 034	1 038	1 043	1 050
	2 800	1 045	1 050	1 055	1 060	1 067
	2 900	1 192	1 197	1 202	1 208	1 215
	3 000	1 206	1 212	1 217	1 222	1 230
	3 100	1 223	1 229	1 234	1 240	1 247
	3 200	1 239	1 245	1 251	1 256	1 264
	3 300	1 255	1 261	1 267	1 272	1 280

## OVERHEAD FRAME

INSTALLATION OPENING, HEIGHT, MM	INSTALLATION OPENING, WIDTH, MM						
	2 000	2 100	2 200	2 300	2 400	2 500	2 600
1 800	766	793	796	800	805	940	945
1 900	778	805	809	944	949	953	958
2 000	791	819	822	957	963	967	972
2 100	803	962	966	970	976	980	985
2 200	816	976	980	984	990	994	1 000
2 300	966	999	1 003	1 007	1 014	1 151	1 157
2 400	992	1 027	1 031	1 036	1 042	1 181	1 187
2 500	1 019	1 054	1 059	1 064	1 071	1 212	1 218
2 600	1 040	1 076	1 081	1 222	1 229	1 234	1 241
2 700	1 055	1 092	1 097	1 238	1 245	1 251	1 257
2 800	1 072	1 246	1 251	1 256	1 264	1 269	1 276
2 900	1 220	1 262	1 268	1 273	1 280	1 286	1 293
3 000	1 235	1 278	1 283	1 289	1 297	1 302	1 309
3 100	1 253	1 297	1 302	1 308	1 316	1 322	1 329
3 200	1 270	1 314	1 320	1 326	1 334	1 340	1 347
3 300	1 286	1 331	1 337	1 343	1 351	1 358	1 365

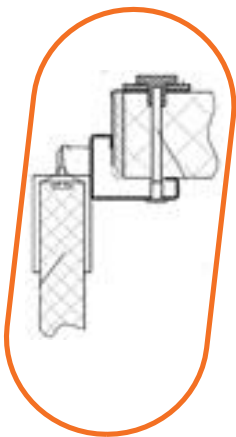

## ANGULAR FRAME

INSTALLATION OPENING, HEIGHT, MM	INSTALLATION OPENING, WIDTH, MM				
	1 000	1 100	1 200	1 300	1 400
1 800	711	717	728	732	797
1 900	720	726	737	741	810
2 000	728	735	746	750	822
2 100	737	743	755	759	835
2 200	746	752	764	768	847
2 300	766	772	784	789	872
2 400	784	791	806	810	898
2 500	936	943	958	963	1 055
2 600	952	959	974	979	1 075
2 700				991	1 090
2 800				1 002	1 105
2 900				1 151	1 257
3 000				1 164	1 274
3 100				1 175	1 291
3 200				1 187	1 306
3 300				1 198	1 321

## ANGULAR FRAME

INSTALLATION OPENING, HEIGHT, MM	INSTALLATION OPENING, WIDTH, MM				
	1 500	1 600	1 700	1 800	1 900
1 800	801	804	808	812	817
1 900	813	817	821	825	831
2 000	826	830	834	838	844
2 100	839	843	847	851	857
2 200	852	856	860	865	871

RAL 9003	2 300	877	881	886	890	1027
	2 400	903	907	912	917	1055
	2 500	1060	1064	1069	1074	1081
	2 600	1080	1085	1090	1095	1103
	2 700	1095	1100	1106	1111	1118
	2 800	1110	1116	1121	1126	1134
	2 900	1263	1269	1274	1280	1287
	3 000	1279	1285	1291	1297	1304
	3 100	1297	1302	1308	1314	1322
	3 200	1312	1318	1324	1330	1338
	3 300	1327	1333	1339	1346	1354

## ANGULAR FRAME

	INSTALLATION OPENING, HEIGHT, MM	INSTALLATION OPENING, WIDTH, MM						
		2 000	2 100	2 200	2 300	2 400	2 500	2 600
RAL 9003	1800	823	852	856	859	865	1004	1010
	1900	837	866	870	1006	1012	1019	1025
	2 000	850	880	884	1021	1027	1033	1040
	2 100	864	1027	1031	1035	1042	1048	1055
	2 200	877	1041	1046	1050	1057	1063	1070
	2 300	1034	1070	1074	1079	1086	1227	1234
	2 400	1062	1099	1104	1109	1116	1259	1266
	2 500	1088	1126	1131	1136	1144	1288	1295
	2 600	1110	1148	1154	1296	1304	1311	1319
	2 700	1126	1165	1170	1313	1321	1328	1336
	2 800	1142	1319	1324	1330	1338	1345	1353
	2 900	1295	1340	1346	1351	1359	1367	1375
	3 000	1312	1358	1364	1370	1378	1386	1394
	3 100	1330	1376	1382	1389	1397	1405	1414
3 200	1347	1393	1400	1406	1414	1423	1431	
3 300	1362	1410	1416	1423	1431	1440	1449	

## OVERLAPPING FRAME

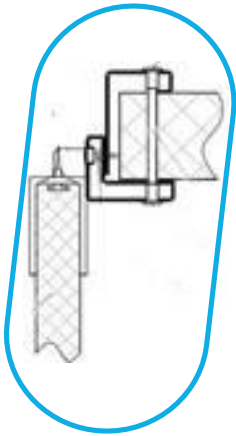

	INSTALLATION OPENING, HEIGHT, MM	INSTALLATION OPENING, WIDTH, MM				
		1 000	1 100	1 200	1 300	1 400
RAL 9003	1800	782	788	800	805	873
	1900	794	801	814	819	890
	2 000	805	812	825	830	904
	2 100	819	825	839	845	923
	2 200	830	836	850	856	938
	2 300	852	859	873	879	965
	2 400	876	883	900	906	997
	2 500	1035	1043	1059	1066	1160
	2 600	1053	1061	1078	1084	1182
	2 700				1099	1201
	2 800				1114	1219
	2 900				1267	1376
	3 000				1285	1398
	3 100				1300	1418
3 200				1313	1435	
3 300				1327	1453	

## OVERLAPPING FRAME

	INSTALLATION OPENING, HEIGHT, MM	INSTALLATION OPENING, WIDTH, MM			1800	1900
		1500	1600	1700		
9003	1800	878	883	888	893	900
	1900	895	900	905	911	918
	2 000	910	915	921	926	934
	2 100	928	934	939	945	953
	2 200	943	949	955	960	968
	2 300	971	977	983	989	1131
	2 400	1003	1009	1016	1022	1166
	2 500	1167	1173	1179	1186	1194

RAL	2 600	1189	1196	1202	1209	1217
	2 700	1207	1214	1221	1228	1237
	2 800	1226	1233	1240	1247	1256
	2 900	1383	1390	1397	1404	1413
	3 000	1405	1412	1419	1427	1436
	3 100	1426	1433	1440	1448	1457
	3 200	1442	1450	1457	1465	1475
	3 300	1461	1468	1476	1484	1494

## OVERLAPPING FRAME

	INSTALLATION OPENING, HEIGHT, MM	INSTALLATION OPENING, WIDTH, MM						
		2 000	2 100	2 200	2 300	2 400	2 500	2 600
RAL 9003	1800	906	939	944	949	957	1099	1111
	1900	925	958	963	1105	1113	1119	1131
	2 000	940	974	980	1122	1130	1137	1148
	2 100	960	1131	1137	1143	1151	1158	1169
	2 200	975	1148	1154	1160	1168	1175	1187
	2 300	1138	1179	1185	1191	1199	1345	1358
	2 400	1174	1216	1222	1228	1237	1385	1398
	2 500	1202	1245	1251	1258	1266	1415	1427
	2 600	1225	1269	1275	1423	1432	1440	1452
	2 700	1244	1289	1296	1443	1452	1460	1473
	2 800	1264	1449	1456	1463	1473	1481	1494
	2 900	1422	1471	1479	1486	1495	1504	1517
	3 000	1444	1495	1503	1510	1520	1528	1542
	3 100	1466	1517	1525	1533	1542	1551	1565
	3 200	1483	1536	1543	1551	1561	1570	1584
	3 300	1503	1556	1563	1571	1582	1591	1605

OUR DOORS ARE AVAILABLE IN CUSTOM SIZES TO INSURE BEST COMMERCIAL APPLICATION

## DOOR CATALOGUE CODES

TSD	SWINGING SINGLE LEAF DOORS
TDD	SWINGING DOUBLE LEAF DOORS
RIGHT / LEFT	HINGES ON THE RIGHT / HINGES ON THE LEFT

### EXAMPLE OF DOOR CATALOGUE CODE: TSD 800 2000 40 RAL9003/RAL9003 ANG RIGHT

DOOR TYPE	DOORWAY WIDTH	DOORWAY HEIGHT	DOOR THICKNESS	COVERING MATERIAL		FRAME TYPE	HINGES LOCATION
				EXTERIOR METAL	INTERIOR METAL		
TSD	800	2 000	40	RAL9003	RAL9003	ANGULAR	RIGHT

## ADDITIONAL OPTIONS FOR TRAFFIC SWINGING DOORS

ITEM	PRICE
TDD FRAME INSTALLATION HARDWARE TO INSULATED SANDWICH PANELS .....	13
TSD FRAME INSTALLATION HARDWARE TO INSULATED SANDWICH .....	10
TDD FRAME INSTALLATION HARDWARE TO A BRICK WALL .....	8
TSD FRAME INSTALLATION HARDWARE TO A BRICK WALL .....	4
FRAME INSTALLATION HARDWARE FOR STEEL STUD CONSTRUCTION .....	3
DOOR BLADE MATERIAL: AISI 304, PRICE FOR 1 SQ. M .....	35
DOOR BLADE MATERIAL: AISI 430, PRICE FOR 1 SQ. M .....	23
OVERHEAD FRAME AISI 304, PRICE FOR RUNNING METER .....	20
ANGULAR FRAME AISI 304, PRICE FOR RUNNING METER .....	33
OVERLAPPING FRAME AISI 304, PRICE FOR RUNNING METER .....	87
OVERHEAD FRAME AISI 430, PRICE FOR RUNNING METER .....	11
ANGULAR FRAME AISI 430, PRICE FOR RUNNING METER .....	20

OVERLAPPING FRAME AISI 430, PRICE FOR RUNNING METER	51
HIDDEN INSTALLATION HARDWARE FOR TSD	47
HIDDEN INSTALLATION HARDWARE FOR TDD	56
HIDDEN INSTALLATION HARDWARE FOR TSD WITH AISI 304 FRAME	65
HIDDEN INSTALLATION HARDWARE FOR TDD WITH AISI 304 FRAME	58
HIDDEN INSTALLATION HARDWARE FOR TSD WITH AISI 430 FRAME	76
HIDDEN INSTALLATION HARDWARE FOR TDD WITH AISI 304 FRAME	68

## FACTORY INSTALLED BUMPERS FOR TSD

BUMPER MATERIAL	THICKNESS, MM	PRICE FOR SQ. M	PRICE FOR RUNNING METER	
			BOTTOM 0,25 M	BOTTOM 0,5 M
AISI 304	1,5	115	29	58
AISI 430	1,5	77	19	38
ALUMINIUM CHECKER PLATE	1,5	61	15	30
FLAT HDP PLASTIC	4,0	34	9	17
CURVED HDP PLASTIC	6,0	50	12	25

## FACTORY INSTALLED BUMPERS FOR TDD

BUMPER MATERIAL	THICKNESS, MM	PRICE FOR SQ. M	PRICE FOR RUNNING METER	
			BOTTOM 0,25 M	BOTTOM 0,5 M
AISI 304	1,5	121	30	61
AISI 430	1,5	80	20	40
ALUMINIUM CHECKER PLATE	1,5	64	16	32
FLAT HDP PLASTIC	4,0	35	9	18
CURVED HDP PLASTIC	4,0	41	10	20
CURVED HDP PLASTIC	6,0	51	13	25

## PACKAGING

ITEM	PRICE
STRETCH-WRAP	INCLUDED IN DOOR PRICE
CARDBOARD PACKAGING	CALCULATED INDIVIDUALLY FOR YOUR ORDER
WOODEN PACKAGING	CALCULATED INDIVIDUALLY FOR YOUR ORDER



+7 (495) 745-01-37

[WWW.PROFHOLOD.COM](http://WWW.PROFHOLOD.COM)